

FILED & RECORDED
IN MARTIN COUNTY, FLA.
1959 OCT 27 PM 2:18
DOROTHY PIERCE, CLERK
J. H. Evans

BEGIN SURVEY

Scale: 1/2 Inch = 1 Mile

T375
T385
T395

R37E						R38E						R39E						R40E																	
OKEECHOBEE CO.												ST. LUCIE CO. MARTIN CO.												OKEECHOBEE CO.											
6	5	4	3	2	1	6	5	4	3	2	1	6	5	4	3	2	1	6	5	4	3	2	1												
7	8	9	10	11	12	7	8	9	10	11	12	7	8	9	10	11	12	7	8	9	10	11	12												
18	17	16	15	14	13	18	17	16	15	14	13	18	17	16	15	14	13	18	17	16	15	14	13												
19	20	21	22	23	24	19	20	21	22	23	24	19	20	21	22	23	24	19	20	21	22	23	24												
30	29	28	27	26	25	30	29	28	27	26	25	30	29	28	27	26	25	30	29	28	27	26	25												
31	32	33	34	35	36	31	32	33	34	35	36	31	32	33	34	35	36	31	32	33	34	35	36												

END SURVEY

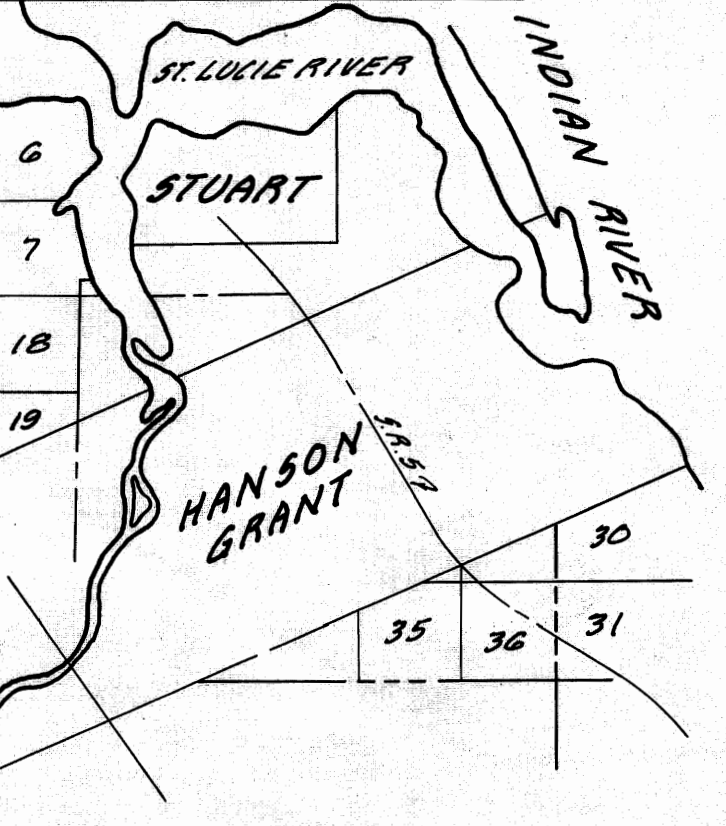

We, Ralph Davis, as Director of the State Road Department of the State of Florida, and L. A. Fraleigh, as Secretary of the State Road Department of the State of Florida, do hereby certify that this map is the Official Map of Location and Survey of a portion of section 89090, designated as a part of State Road 714 in Martin County, Florida: said portion of section 89090 extending from Okeechobee County line easterly to the southeast corner of section 15, Township 38 South, Range 40 East.

Prepared and adopted by the State Road Department of the State of Florida under provisions of section 335.02, Florida Statutes of 1955.

Ralph Davis
Director, State Road Department

Attest: L. A. Fraleigh
Secretary, State Road Department

Approved: [Signature]
Engineer of Rights of Way

Filed for record in the Office of the Clerk of the Circuit Court for the County of Martin, State of Florida, in Map Book 3, Page 122, on the 27 day of October, A.D. 1959.

Dorothy Pierce
Clerk of the Circuit Court
Martin County, Florida